

# 193 Bowery

SUSAN PENZNER Real Estate Exclusive

*Join Citizen M at the intersection of Spring Street*



**Ground:** Approx. 2,250sf

**Basement:** Approx. 2,000sf

**Term:** 1-10 years

**Rent:** \$100/sf

**Possession:** Immediate

**Description:** Ground floor adjacent to new Citizen M Hotel. Approx. 11ft ceilings. High pedestrian and vehicular visibility. Dry uses only.

Former kitchen-supply store.  
Space currently in raw condition.

Neighbors include Pop International Gallery, Nudie Jeans, Hit House boxing, Totokaelo, Nest Bedding, GROUPE Menswear, Sieize Sur Vingt.

**Shown by appointment only.**

Contact:

Nathan Stange 212-343-1909 x13  
[nathan@susanpenzner.com](mailto:nathan@susanpenzner.com)

Susan Penzner 212-343-1909 x11  
[susan@susanpenzner.com](mailto:susan@susanpenzner.com)



No representation is made as to the accuracy of any information furnished. All square footage is approximate and based on gross square footage. Offer subject to errors, omissions, change in price, prior sale, and/or withdrawal without notice.

10

SUSA



Bowery

Contact:

Nathan Stange 212-343-1909 x13  
[nathan@susanpenzner.com](mailto:nathan@susanpenzner.com)

Susan Penzner 212-343-1909 x11  
[susan@susanpenzner.com](mailto:susan@susanpenzner.com)

No representation is made as to the accuracy of any information furnished. All square footage is approximate and based on gross square footage. Offer subject to errors, omissions, change in price, prior sale, and/or withdrawal without notice.

# 193 Bowery

SUSAN PENZNER Real Estate Exclusive

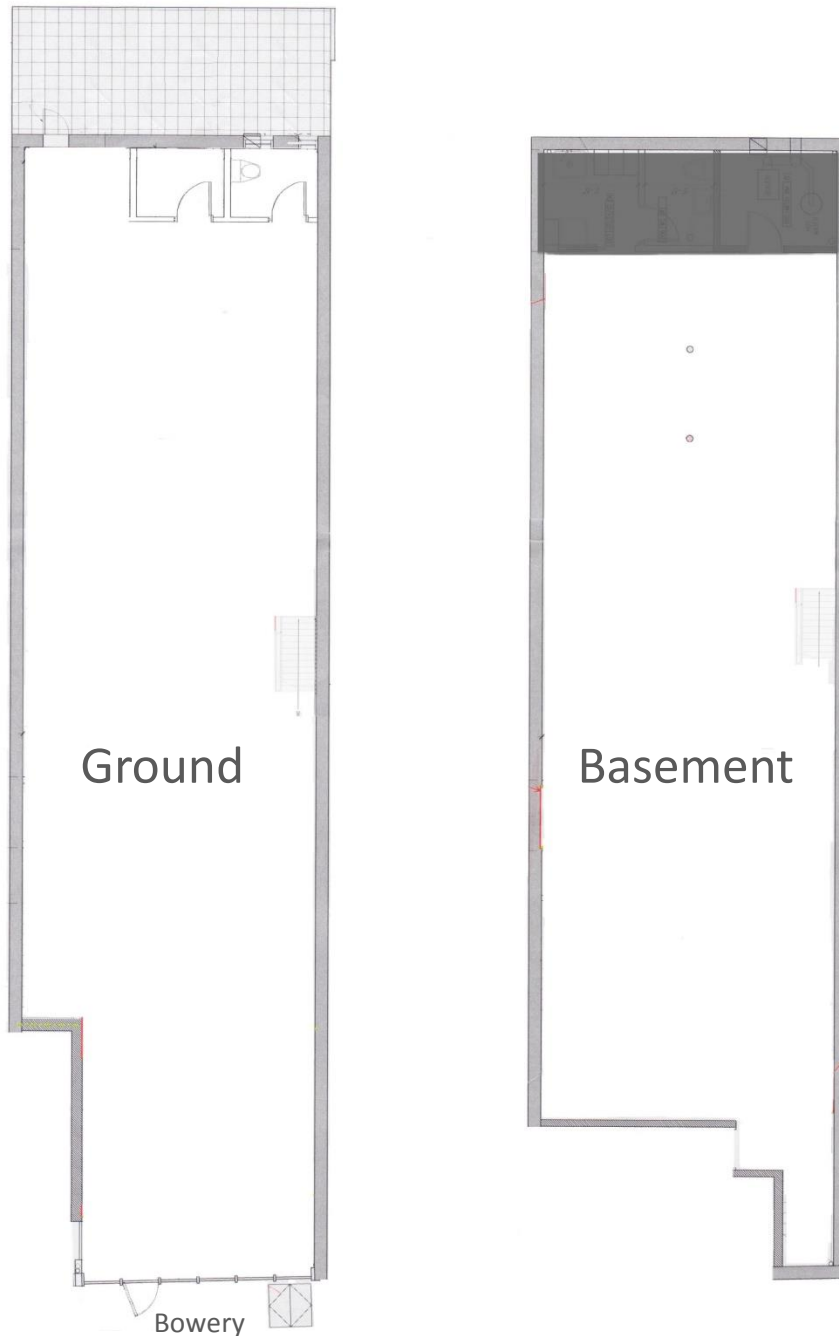

## Contact:

Nathan Stange 212-343-1909 x13  
[nathan@susanpenzner.com](mailto:nathan@susanpenzner.com)

Susan Penzner 212-343-1909 x11  
[susan@susanpenzner.com](mailto:susan@susanpenzner.com)

No representation is made as to the accuracy of any information furnished. All square footage is approximate and based on gross square footage. Offer subject to errors, omissions, change in price, prior sale, and/or withdrawal without notice.